

Bay LANDS



QMA Track Checklist

Please fill in all information boxes and return form to Vice President, Michelle Barzee

Track Dimensions:

Track Width:	32 1/2	feet
Infield Width:	32	feet
Infield Length:	129	feet
Overall Track Length:	194	feet

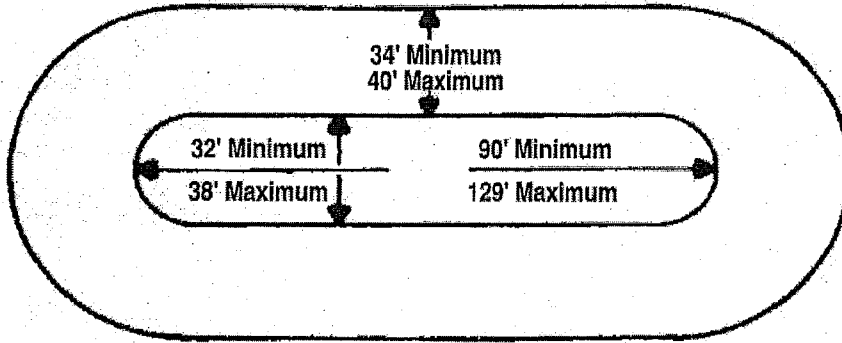

Figure 1: Track Dimension Detail

Speed Breakers (or huggy poles for Dirt tracks):

Quantity per end: (minimum 5)

Distance from corner line to breaker:

5	breakers or poles
5	qty
3"	inches

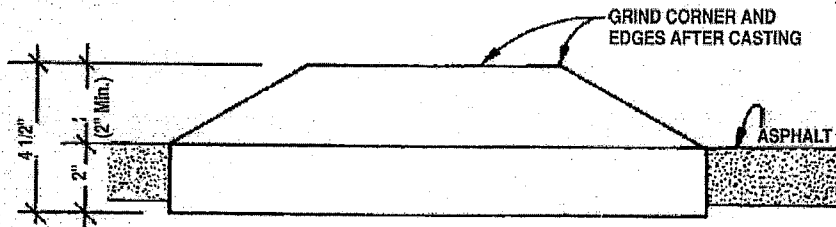
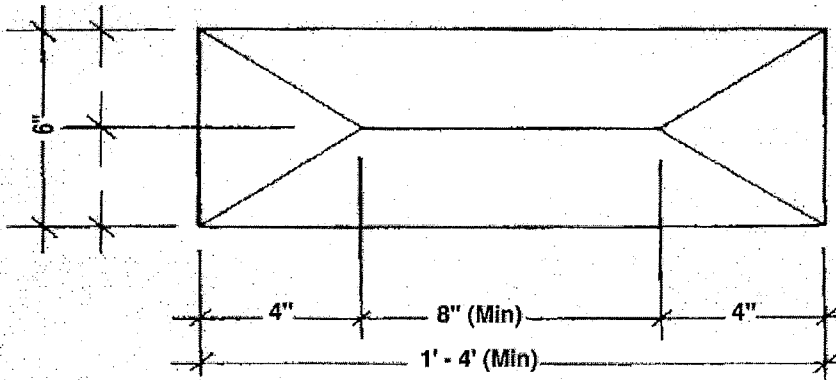
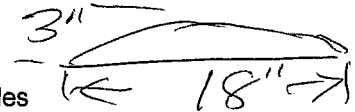

Figure 2: Speed Breaker Detail

Reference Lines:

Length:

feet

Distance from apex of corner:

feet

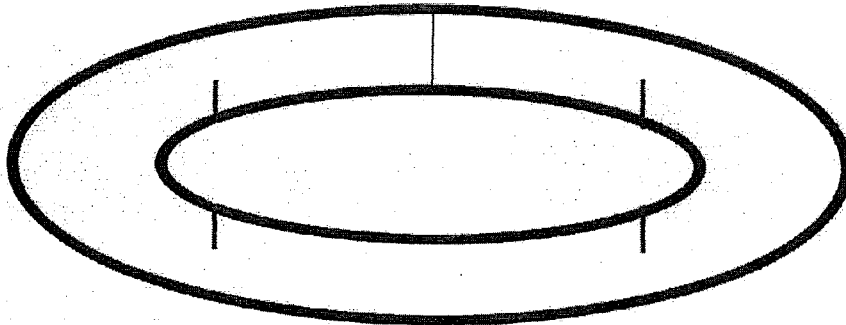

Reference lines should be approx. 12-15 feet from the apex of the turn. It should be approx. 5 feet long & approx. 3-6 inches thick. This line is to help the Judges find where the drivers should be yielding. It will also help the driver know when to yield if he or she doesn't have the pass made cleanly.

Figure 3: Reference Lines Detail

Work Area:

Location:

- END of hot chute

Dimensions:

feet x feet

Handler Safe Area:

Yes / No

Corner Person Locations:

(4 corner persons required)

Quantity:

Locations:

TOWER Straight
Between 1 + 2
turn
turn

(ex. Turn 1, 2, 3, 4)

Soft Walls:

Yes / No

Emergency Information Posted:

EMS Service

Yes / No

Fire

Yes / No

Police

Yes / No

Medical Facility (Number & Map)

Yes / No

(Provide copy with checklist)

Flagger:

Off track:

Yes / No

Location:

Judges Location:

Off track:

Yes / No

Location:

Caution Lights:

Location:

Yes / No

Number:

TURN 1 + 3

* (Please include photos of any items for clarification, if necessary)